

DESIGN DATA	
CAPACITY	1000 GALLONS
TYPE	ABOVEGROUND VERTICAL SINGLE WALL
NO. REQ.	(1)
OPERATING PRESSURE	ATMOSPHERIC
TANK MATERIAL	MILD CARBON STEEL
THICKNESS	7 GA. THROUGHOUT
CONSTRUCTION	LAP WELD ALL EXTERIOR SEAMS
TANK TEST	2 PSIG
INT. PREP	SSPC-SP 10 BLAST
INT. FINISH	HighDRO®-LINER PLUS POLYURETHENE (15 MILS)
EXT. PREP	SSPC-SP 6 BLAST
EXT. FINISH	(2) COATS WHITE URETHANE
LEGEND	
A	2" FNPT CONNECTION
B	6" FNPT CONNECTION (PRIMARY VENT USE)
C	2 1/2" FNPT CONNECTION - WITH DOPED CAST IRON PLUG
D	2" FNPT FULL CPLG. CONNECTION WITH OPTIONAL 2" DROP PIPE WITH HOLES PER CUSTOMERS SPECIFICATION - TRANSDUCER
E	2" FNPT FULL CPLG. CONNECTION WITH 2" DIA DROP PIPE - FILL
F	1-1/4" FNPT CONNECTION
G	24" CLOSE BOLT MANWAY WITH 1/8" THICK NEO-CORK GASKET THICKNESS NOZZLE- 1/4" THICKNESS FLANGE- 1/4" THICKNESS COVER- 3/8"

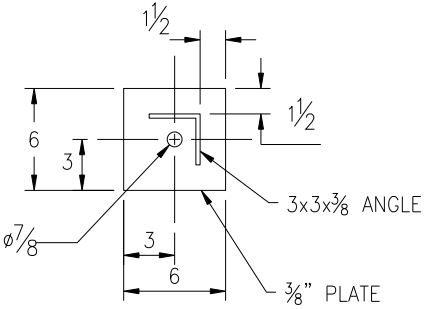

BASE PLATE DETAIL

NOTE: ALL RIGHTS RESERVED. THIS  
DRAWING MUST NOT BE REPRODUCED IN  
ANY FORM WITHOUT THE WRITTEN  
PERMISSION OF HIGHLAND TANK®.  
HIGHLAND TANK® SHALL BE RESPONSIBLE  
ONLY FOR ITEMS INDICATED ON THIS  
FABRICATION DRAWING UNLESS OTHERWISE  
NOTED. CUSTOMER IS RESPONSIBLE FOR  
VERIFYING CORRECTNESS OF SIZE AND  
LOCATION OF FITTINGS, ACCESSORIES, AND  
COATINGS SHOWN ON THIS DRAWING.

TOUCH UP OF FINISHED PAINT IS  
REQUIRED BY INSTALLATION  
CONTRACTOR. TOUCH UP PAINT SHIPPED  
WITH TANK.



**Highland Tank®**

HighDRO® WATER STORAGE TANKS  
1,000 GALLON VERTICAL DAY TANK

CUSTOMER:

PROJECT:

QUOTE NO:

CHK'D BY:

SCALE:

DATE:

DWG BY:

DWG NO:

NTS

9/7/10

MGS

01000AVSWHDDT64