

NOTE: ALL RIGHTS RESERVED. THIS DRAWING MUST NOT BE REPRODUCED IN ANY FORM WITHOUT THE WRITTEN PERMISSION OF HIGHLAND TANK. HIGHLAND TANK SHALL BE RESPONSIBLE ONLY FOR ITEMS INDICATED ON THIS FABRICATION DRAWING UNLESS OTHERWISE NOTED. CUSTOMER IS RESPONSIBLE FOR VERIFYING CORRECTNESS OF SIZE AND LOCATION OF FITTINGS, ACCESSORIES, AND COATINGS SHOWN ON THIS DRAWING.

TOUCH UP OF FINISHED PAINT IS REQUIRED BY INSTALLATION CONTRACTOR. TOUCH UP PAINT SHIPPED WITH TANK.

- NOTES
1. SEE PLAN VIEW FOR TRUE ORIENTATION AND LOCATION OF FITTING
 2. LIFTING LUGS FOR UNLOADING UNIT & STANDING UNIT UPRIGHT TO BE PLACED AS NEEDED BY FABRICATION SHOP
 3. A 3x3x $\frac{1}{4}$ " STEEL GROUNDING LUG WITH A $\frac{3}{8}$ " ϕ HOLE IN CENTER TO BE PLACED ON SHELL AT BOTTOM OF TANK IN LINE WITH LIFTING LUGS

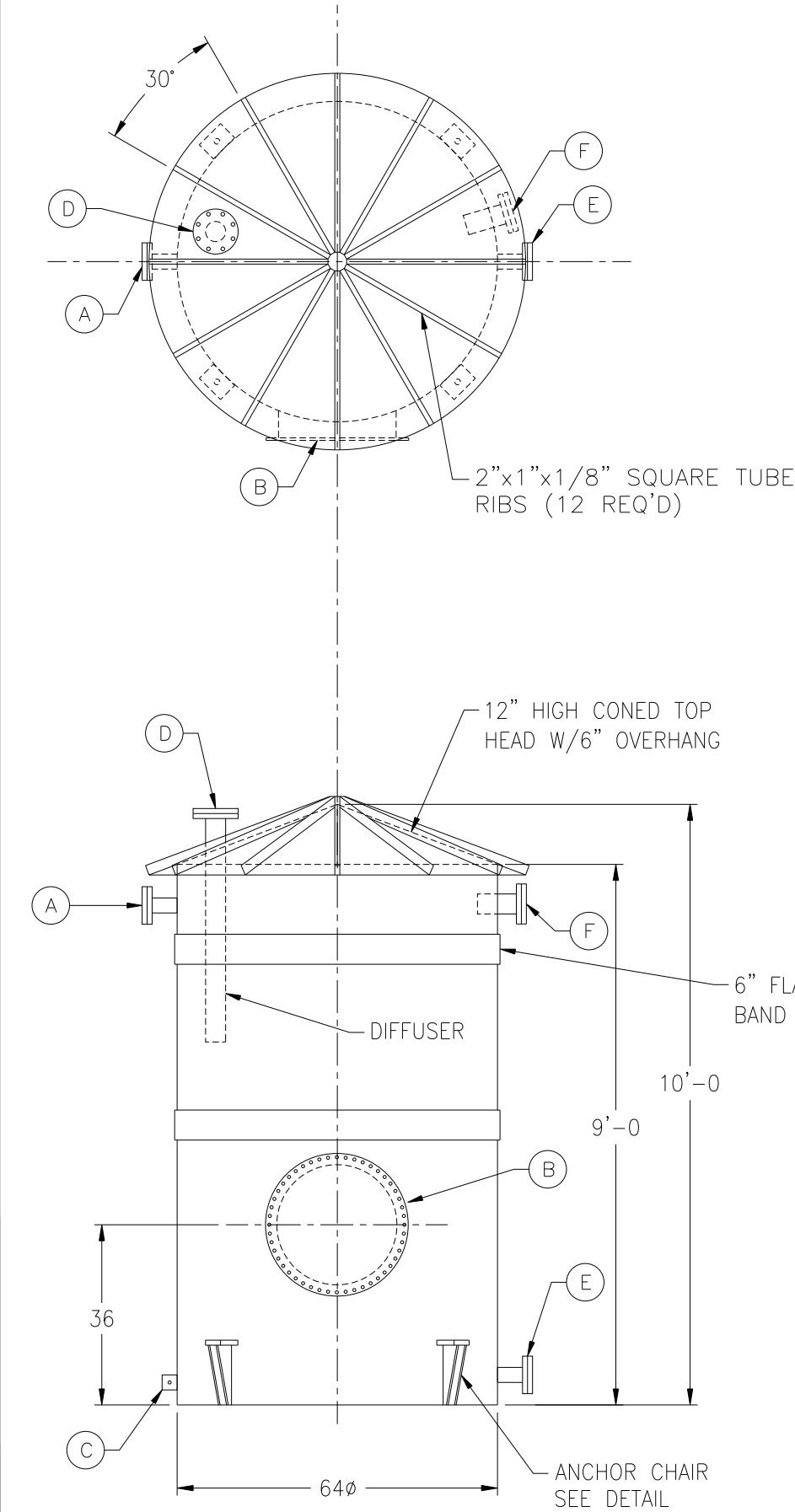

| DESIGN DATA | |
|---|--|
| CAPACITY – 1,500 GALLON | |
| TYPE – SINGLE WALL ABOVEGROUND VERTICAL | |
| NO. REQ. – | |
| OPERATING PRESSURE – ATMOSPHERIC | |
| SPECIFIC GRAVITY = 1.0 | |
| TANK MATERIAL – MILD CARBON STEEL | |
| THICKNESS – TOP HEAD: 7 GA CONE WITH 2"x1" SQ. TUBE REINFORCEMENT | |
| THICKNESS – BOTTOM HEAD: 1/4" FLAT | |
| THICKNESS – SHELL: 1/4" | |
| CONSTRUCTION – LAP WELD INSIDE & OUTSIDE | |
| TANK TEST – 2 PSIG | |
| INT. FINISH – SSPC-SP 10 BLAST HighDRO®-LINER PLUS POLYURETHENE (15 MILS) | |
| EXT. FINISH – SSPC-SP 6 BLAST EXTERIOR OF BOTTOM HEAD TO BE COATED W/ 25 MILS POLYURETHANE PRIOR TO TOP COATS ENTIRE EXTERIOR: (2) COATS WHITE URETHANE | |
| LABEL – | |
| LEGEND | |
| A | VENT – 4" 150# RFSO FLANGE WITH BLIND |
| B | 24" X 1/4" PLATE TIGHT BOLT MANWAY WITH 1/8" THICK NEO-CORK GASKET |
| C | GROUNDING LUG WITH 5/8" HOLE |
| D | INLET – 4" 150# RFSO FLANGE WITH BLIND |
| E | OUTLET – 3" 150# RFSO FLANGE WITH BLIND |
| F | OVERFLOW – 4" 150# RFSO FLANGE W/ BLIND |

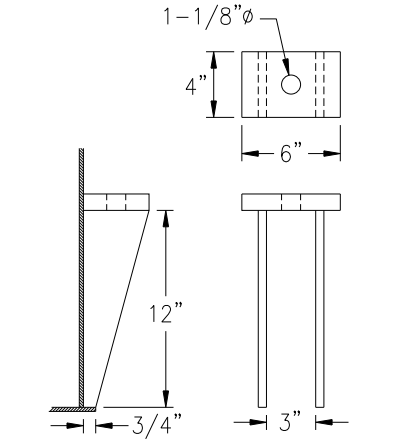

ANCHOR CHAIR DETAIL

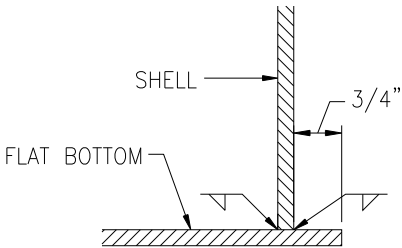

BOTTOM JOINT DETAIL

| | | | |
|--|--------|-----------------------|------------------|
| △ | | | |
| | | Highland Tank® | |
| HighDRO® WATER STORAGE TANKS 1,500 GALLON RAINWATER COLLECTION TANK | | | |
| CUSTOMER: | | | |
| PROJECT: | | | |
| QUOTE NO: | | CHK'D BY: | |
| SCALE: | DATE: | DWG. BY: | DWG. NO: |
| NTS | 9/3/10 | MGS | 01500AVSWHDCST64 |