

NOTE: ALL RIGHTS RESERVED. THIS DRAWING MUST NOT BE REPRODUCED IN ANY FORM WITHOUT THE WRITTEN PERMISSION OF HIGHLAND TANK®. HIGHLAND TANK® SHALL BE RESPONSIBLE ONLY FOR ITEMS INDICATED ON THIS FABRICATION DRAWING UNLESS OTHERWISE NOTED. CUSTOMER IS RESPONSIBLE FOR VERIFYING CORRECTNESS OF SIZE AND LOCATION OF FITTINGS, ACCESSORIES, AND COATINGS SHOWN ON THIS DRAWING.

TOUGH UP OF FINISHED PAINT IS REQUIRED BY INSTALLATION CONTRACTOR. TOUCH UP PAINT SHIPPED WITH TANK.

SHIPPING LUGS AS NEEDED

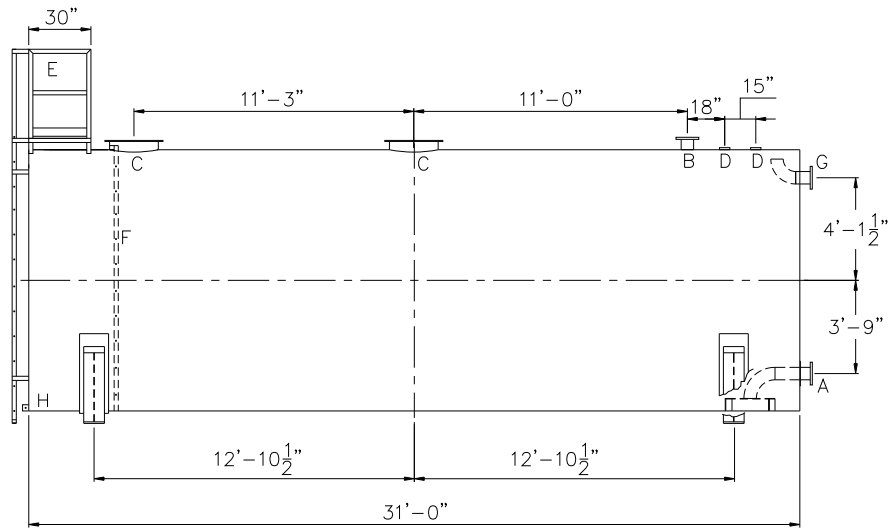
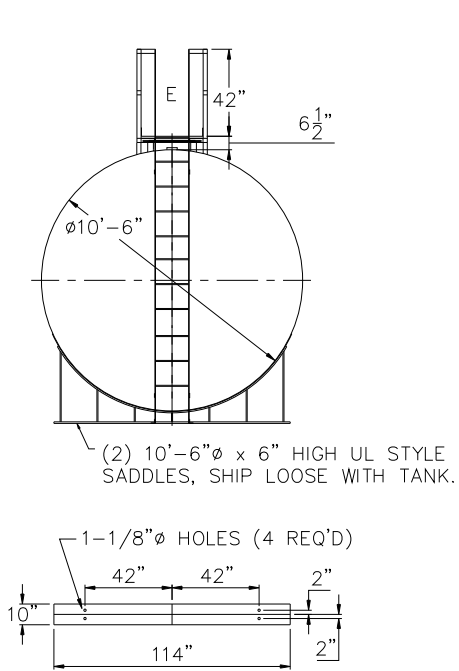

DESIGN DATA	LEGEND
CAPACITY -20,000 GALLONS	A FLANGE WITH INTERNAL VORTEX BREAKER PER NFPA 22
TYPE - FIRE PROTECTION TANK (FPT)	B FLANGE - VENT
NO. REQ. -	C 24" X 1/4" PLATE TIGHT BOLT MANWAY WITH 1/8" THICK NEO-CORK GASKET
OPERATING PRESSURE -ATMOSPHERIC	D 4" FNPT CONNECTION
TANK MATERIAL - MILD CARBON STEEL	E STD HTM EXTERNAL LADDER & PLATFORM ASSEMBLY - PAINTED SAFETY YELLOW AND SHIPPED LOOSE FOR INSTALLATION ON SITE BY OTHERS
THICKNESS: HEADS - 5/16"	F HTM STD INTERNAL LADDER
THICKNESS: SHELL - 1/4"	G FLANGE WITH INTERNAL 90° ELBOW SHOWN - OVERFLOW
CONSTRUCTION -LAP WELD INSIDE & OUTSIDE	H FB-3"x 1/4"x3" WITH 5/8"Ø HOLE ON CL (GROUNDING LUG)
TANK TEST -5 PSIG	
INT. FINISH - SSPC SP10 BLAST, HighDRO®-LINER PLUS FOR NFPA 22 APPLICATIONS	
EXT. FINISH -SSPC SP6 BLAST, WHITE URETHANE PAINT	
LABEL - NONE	

					
		Highland Tank[®]			
HighDRO [®] WATER STORAGE TANK					
20,000 GAL 126"Ø AH FIRE PROTECTION TANK					
CUSTOMER:					
PROJECT:					
QUOTE NO:				CHK'D BY:	
SCALE:	DATE:	DWG. BY:	DWG. NO.		
3/16"=1'-0"	XX/XX/XX	XXX	20000AHSWHDFT126		