

NOTE: ALL RIGHTS RESERVED. THIS DRAWING MUST NOT BE REPRODUCED IN ANY FORM WITHOUT THE WRITTEN PERMISSION OF HIGHLAND TANK®. HIGHLAND TANK® SHALL BE RESPONSIBLE ONLY FOR ITEMS INDICATED ON THIS FABRICATION DRAWING UNLESS OTHERWISE NOTED. CUSTOMER IS RESPONSIBLE FOR VERIFYING CORRECTNESS OF SIZE AND LOCATION OF FITTINGS, ACCESSORIES, AND COATINGS SHOWN ON THIS DRAWING.

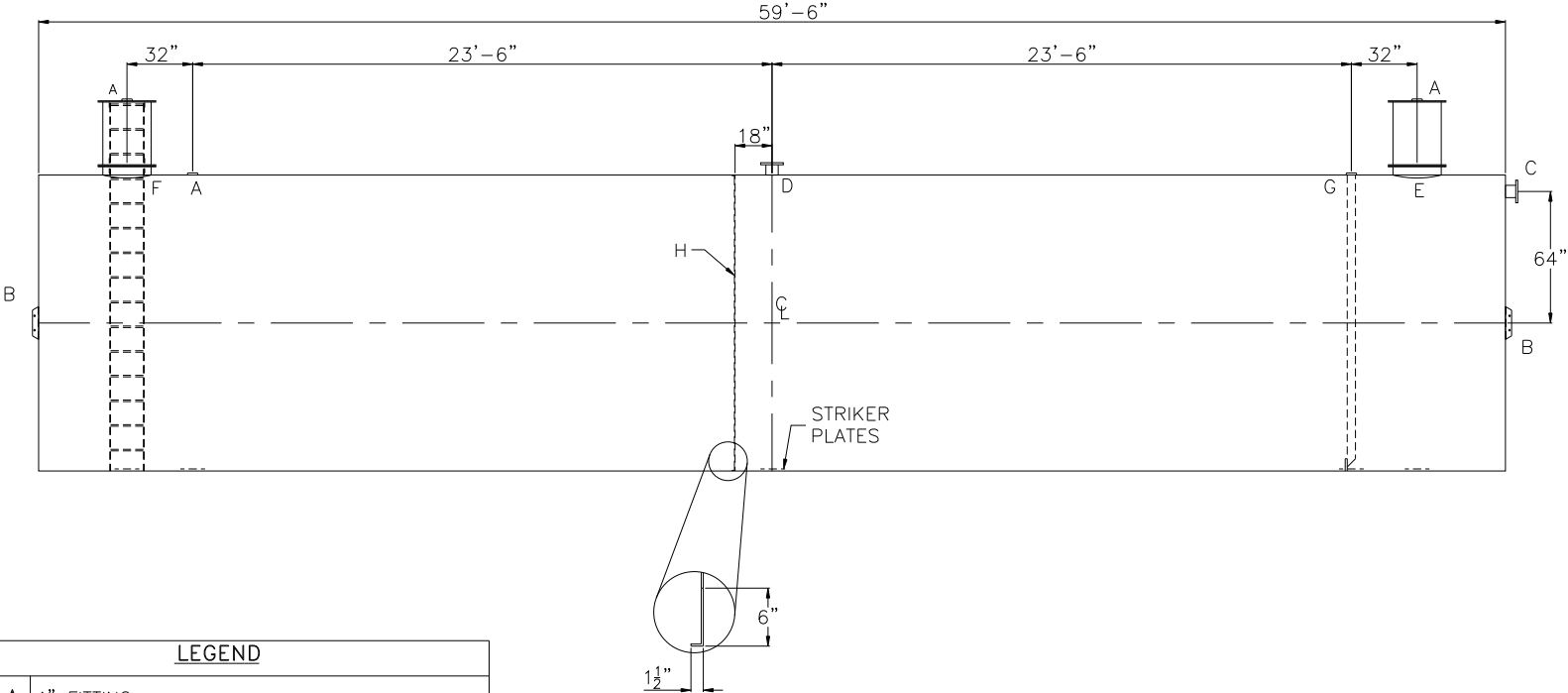
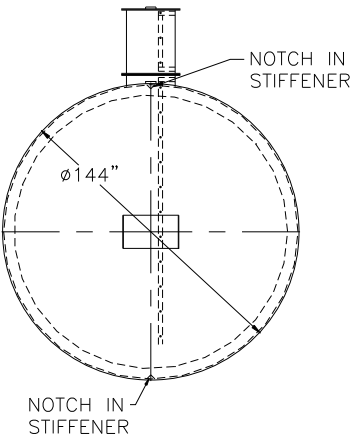

LEGEND

A	4" FITTING
B	HTM SPIN BRK'T - MFG USE ONLY - NOT TO BE USED FOR FIELD INSTALLATION
C	FLANGE - INLET
D	FLANGE - VENT
E	24"Ø TIGHT BOLT MANWAY w/ 1/8" NEO-CORK GASKET MATERIAL AND BOLT ON EXTENSION - EXTENSION SHIPS LOOSE FOR INSTALLATION ON SITE BY OTHERS
F	24"Ø TIGHT BOLT MANWAY w/ 1/8" NEO-CORK GASKET MATERIAL AND BOLT ON EXTENSION - EXTENSION SHIPS LOOSE FOR INSTALLATION ON SITE BY OTHERS, INCLUDES INTERNAL ACCESS LADDER
G	4" FITTING WITH 4" SCH 40 DROP PIPE
H	STIFFENER- 3/8" x 1-1/2" x 6"

- NOTES:
- 1) THE HIGHGUARD TANK IS NOT APPROVED FOR THE STORAGE OF HEATED PRODUCTS.
 - 2) 15,000 VOLT SPARK TEST PROVIDED AT FACTORY.
 - 3) SHOP TO INSTALL 1/4"x12"x12" STRIKER PLATES, ROLLED AND SEAL WELD TO THE TANK.

DESIGN DATA
CAPACITY - 50,000 GALLONS
TYPE - SINGLE WALL, WASTEWATER STORAGE TANK
NO. REQ. - -
OPERATING PRESSURE - ATMOSPHERIC
TANK MATERIAL - MILD CARBON STEEL
THICKNESS - HEADS- 5/16"
THICKNESS - SHELL- 3/8"
*GA THK. BASED ON 60" MAX. BURIAL DEPTH
CONSTRUCTION - FLAT FLANGED HEADS, LAP WELD ALL EXTERIOR SEAMS ONLY
TANK TEST - 5 PSIG
INT. FINISH - SP10 BLAST, HighDRO®-LINER PLUS
EXT. FINISH - SP6 BLAST, 75 MILS POLYURETHANE
LABEL - HIGHGUARD

		Highland Tank®	
HighDRO® WATER STORAGE TANK			
50,000 GAL 144"Ø HIGHGUARD WASTEWATER STORAGE TANK			
CUSTOMER:			
PROJECT:			
QUOTE NO:		CHK'D BY:	
SCALE: 3/16"=1'-0"	DATE:	DWG. BY:	DWG. NO: 50000HGSWHDWWST144