

TOUCH UP OF FINISHED PAINT IS
REQUIRED BY INSTALLATION
CONTRACTOR. TOUCH UP PAINT SHIPPED
WITH TANK.

SHIPPING LUGS AS NEEDED

NOTE: ALL RIGHTS RESERVED. THIS
DRAWING MUST NOT BE REPRODUCED IN
ANY FORM WITHOUT THE WRITTEN
PERMISSION OF HIGHLAND TANK®.
HIGHLAND TANK® SHALL BE RESPONSIBLE
ONLY FOR ITEMS INDICATED ON THIS
FABRICATION DRAWING UNLESS OTHERWISE
NOTED. CUSTOMER IS RESPONSIBLE FOR
VERIFYING CORRECTNESS OF SIZE AND
LOCATION OF FITTINGS, ACCESSORIES, AND
COATINGS SHOWN ON THIS DRAWING.

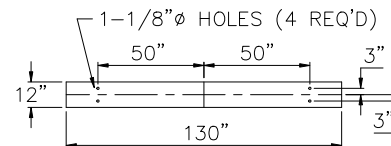
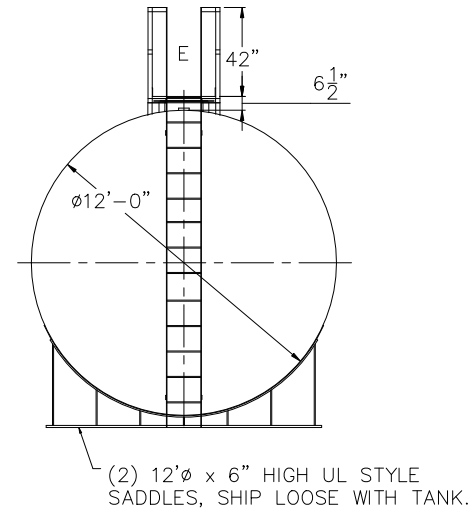
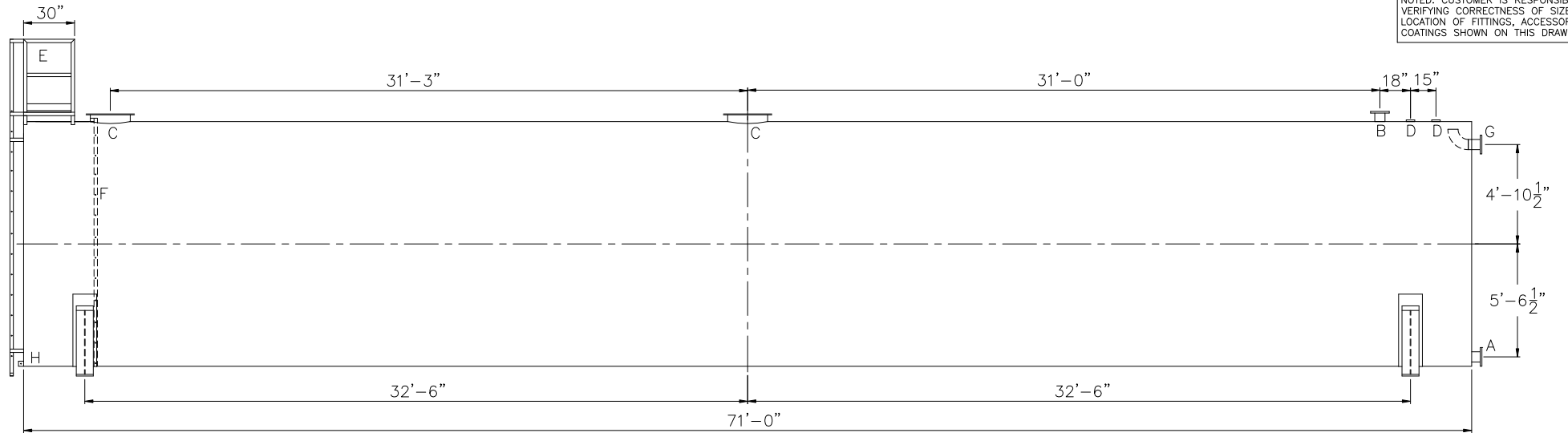

DESIGN DATA	LEGEND
CAPACITY -60,000 GALLONS	A FLANGE - SUPPLY
TYPE - POTABLE WATER TANK (PWT)	B FLANGE - VENT
NO. REQ. -	C 24" X 1/4" PLATE TIGHT BOLT MANWAY WITH 1/8" THICK NEO-CORK GASKET
OPERATING PRESSURE -ATMOSPHERIC	D 4" FNPT CONNECTION
TANK MATERIAL - MILD CARBON STEEL	E STD HTM EXTERNAL LADDER & PLATFORM ASSEMBLY - PAINTED SAFETY YELLOW AND SHIPPED LOOSE FOR INSTALLATION ON SITE BY OTHERS
THICKNESS: HEADS - 3/8"	F HTM STD INTERNAL LADDER
THICKNESS: SHELL - 3/8"	G FLANGE WITH INTERNAL 90° ELBOW SHOWN - OVERFLOW
CONSTRUCTION -LAP WELD INSIDE & OUTSIDE	H FB-3"x 1/4"x3" WITH 5/8"Ø HOLE ON CL (GROUNDING LUG)
TANK TEST -5 PSIG	
INT. FINISH - SP10 BLAST HighDRO®-LINER PLUS FOR NSF 61 APPLICATIONS	
EXT. FINISH -SSPC SP6 BLAST, WHITE URETHANE PAINT	
LABEL - NONE	

					
		Highland Tank			
UNLESS NOTED, TOLERANCES ARE +/- 1"					
HighDRO® WATER STORAGE TANK					
60,000 GAL 144"Ø SINGLE-WALL ABOVEGROUND HORIZONTAL FOR POTABLE WATER WITH BOTTOM DRAIN					
CUSTOMER:					
PROJECT:					
QUOTE NO:				CHK'D BY:	
SCALE: 3/16"=1'-0"	DATE: XX/XX/XX	DWG. BY: XXX	DWG. NO: 60000AHSWHPWTBD144		